



## APPLICATION

The EBB Design extractor fans are suitable for many domestic and commercial ventilation applications where higher system resistance pressures are encountered.

## CONSTRUCTION

The EBB Design fans incorporate a forward curved centrifugal impeller.

## MOTOR

The EBB Design fans are equipped with single-phase 230V, 50Hz, protected against electric shock Class II, degree of protection IP44.

HM and DV models are equipped with 2-speed motors.

Diagram of the electrical connection fig. 15 (model S), fig. 15, 19 (model M), fig. 17 (model T), fig. 1, 16, 19 (model HM), fig. 1 (model DV), p. 662-664.



WWW

DTR

CE



Backdraft shutter



Forward curved centrifugal impeller

## MOUNTING POSITION

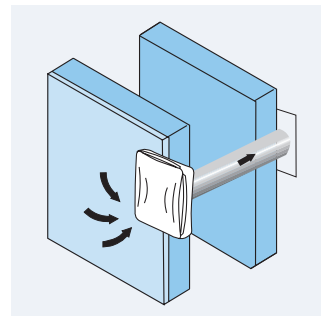
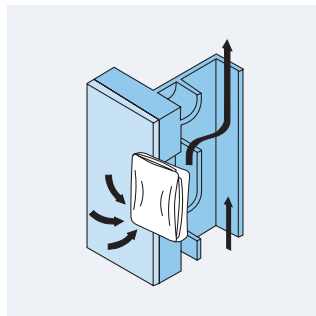
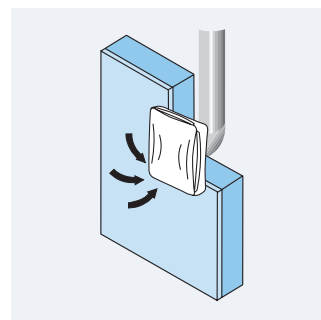
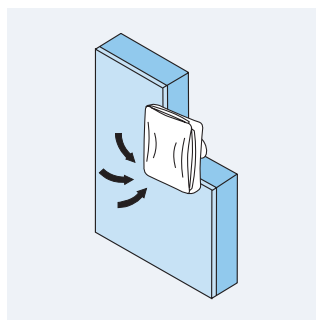

## TECHNICAL CHARACTERISTICS

Type	speed	speed	absorbed power at free discharge	voltage	airflow at free discharge	sound pressure level*	insulation class / IP	weight
		[r.p.m.]						
EBB-175 DESIGN	HS	1250	26	230	155	41	II / IP44	2,20
	LS	930	17		80	33		
EBB-250 DESIGN	HS	1920	72	230	250	51	II / IP44	2,20
	LS	1380	47		175	43		

\* sound pressure level measured at 1,5 m at free air conditions.

## MODEL FEATURES

Type	S	M	T	HM	DV
BALL BEARINGS	•	•	•	•	•
BACKDRAFT SHUTTER	•	•	•	•	•
ON/OFF PULL CORD SWITCH		•		•	•
ONE SPEED MOTOR	•	•	•		
TWO SPEED MOTOR				•	•
ADJUSTABLE RUN-ON-TIMER (from 1 to 30 min)			•		
ADJUSTABLE HUMIDISTAT (60-90 RH%)				•	

## PERFORMANCE CURVES

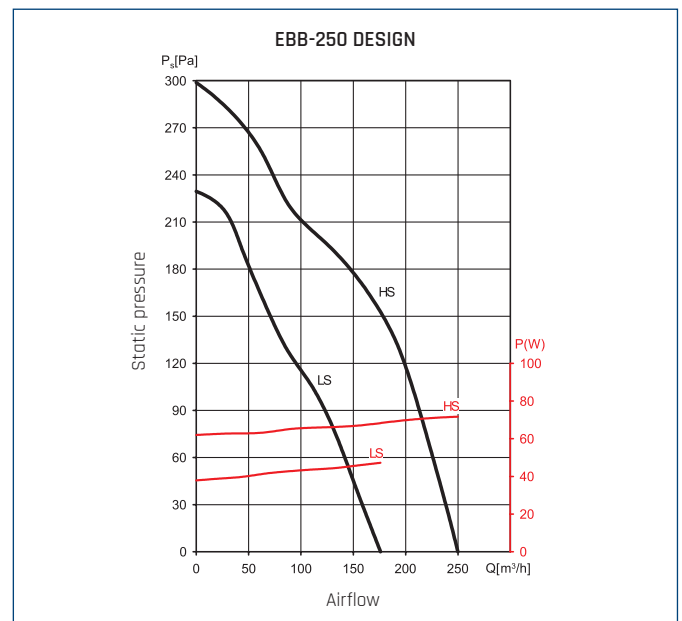
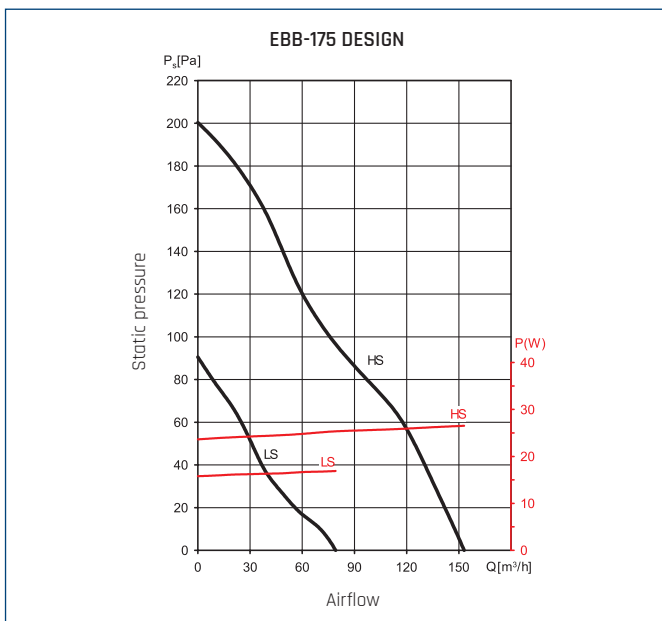

\* 2-speed motors only from HM and DV models.

## DIMENSIONS [mm]

